

## Headset YHS32

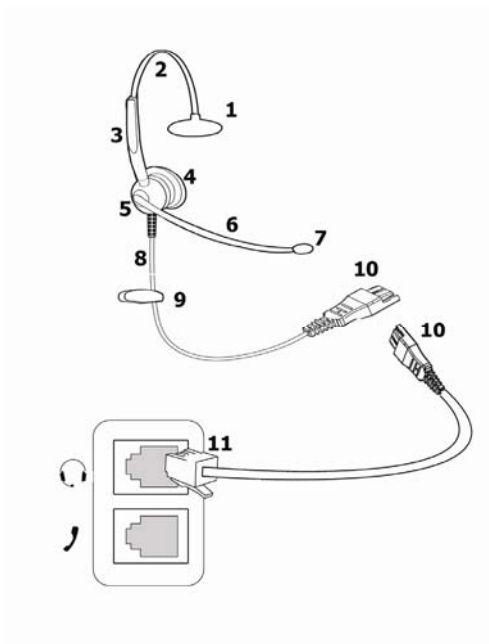





## User Manual

# Components

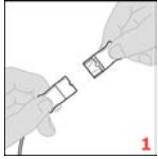
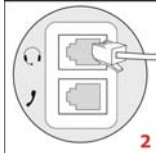

1. T-Bar (limited to one receiver products)
2. Adjustable Headband
3. Adjustment rod
4. Ear cushion
5. Click-Stop Turret
6. Boom
7. Microphone
8. Headset Cable
9. Clothing Clip
10. Quick disconnecter
11. RJ9 Modular Connector

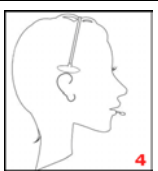
# Connection

Figure	Description
	<p>The headset is equipped with a quick disconnecter. Users can connect the headset to a special adapter to connect to your IP phone.</p>
	<p>The headset are fitted with a standard modular connector. To use the headset models, simply insert the modular connector into the headset port of a compatible telephone.</p>
	<p>To adjust the headband, lengthen or shorten the adjustment rod until it fits comfortably. The click-stop feature keeps the headband securely adjusted. Position the headset receivers so that the foam cushions sit comfortably over the centre of your ears.</p>
	<p>On models with only one receiver, position the T-bar above your ear.</p>
	<p>Hold the receiver securely against your ear with one hand. With the other hand, Use the fixed boom, adjust the microphone to about one finger distance to your lips.</p>
	<p>The clothing clip helps to keep the headset properly positioned and free from the cord's weight. Attach the clothing clip at a comfortable level to liberate your hand.</p>

The Yealink YHS32 is compatible with all of the Yealink Enterprise IP phones. We will take T28P for an example to make a brief description.

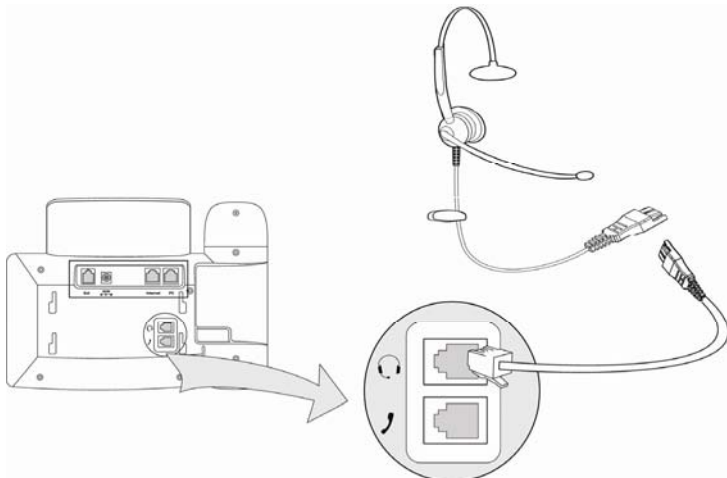

#### Usage:

1. When there is an incoming call to your extension, press the HEADSET button to answer it by the headset mode.
2. During a conversation, press the HEADSET button or pickup the handset, the conversation will switch between the headset mode and the handset mode.